

100%
VAASTU



BHUMIKA BUILDERS, Introduces 3 BHK Deluxe Flats in South Bangalore



Your dream home is our aim

PROXIMITY & NEIGHBORHOOD

- a) Architecturally sound structure with provision for good interior & 100% Vaastu achieved by reputed Architects.
- b) Budget prices, Spacious and Quality construction by reputed builders.
- c) Adequate Parking facility for 4 wheelers & 2 wheelers in the stilt floor.
- d) Provision for gas connection point at utility.
- e) Located in south Bangalore city, near to most of the major places like, BMTC Bus stop, Madhavan Park, Jayanagar BDA Complex, Reputed education institutions like Vjaya College, Major Hospitals.
- f) Approved by leading Financial Institutions.
- g) Interiors can be customized as per your requirements.

STILT FLOOR PLAN

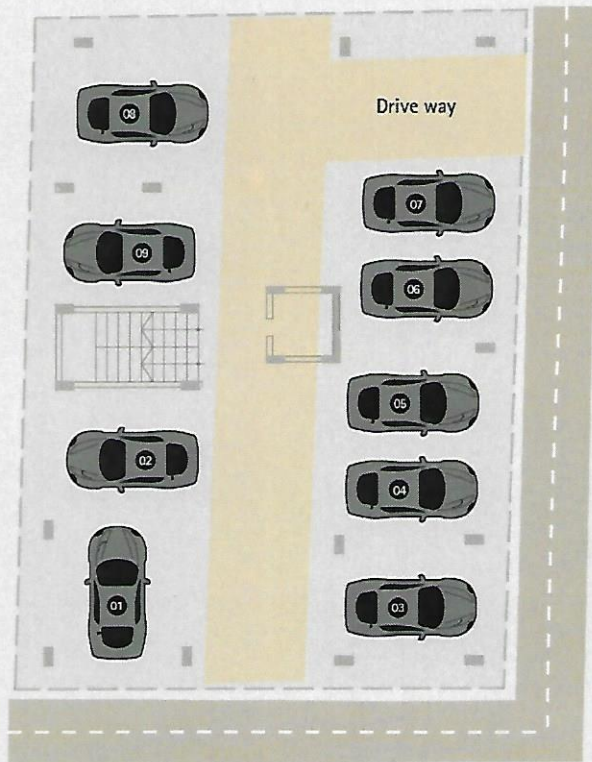

LOCATION MAP



#455, 9th Cross, 1st Block
Near Madhavan Park
Jayanagar, Bangalore - 560 011

m. +91 96862 36845
t. +91 80 2656 2277
e. bhumikakss@rediffmail.com
w. www.bhumikabuilders.in



Site No. 207
Jayanagar 1st Block (east)
1st 'A' Cross, BDA Layout
Bangalore - 560 011

Architect: SUDHIR
+91 98864 06592

TYPICAL FLOOR PLAN



Floors	Flat No.	Super Built-up Area
Stilt	Parking for two & four wheelers	
Ground	101, 102	1,200 sft
First	201, 202	1,200 sft
Second	301, 302	1,200 sft
Third	401, 402	1,200 sft

SPECIFICATIONS

Vaastu

Built as per Vaastu

Structure

- a) RCC Framed Structure
- b) Solid concrete block masonry
- c) Stilt car parking
- d) Lift
- e) DJ set (Generator Backup)

Door & Windows

- a) Main door in Teak wood
- b) All other door frames in Sal-wood & Flush door
- c) Water proof plywood shutter for Toilet & Balcony door
- d) Finesha windows with safety grills

Flooring

- a) Granite flooring for Living, Bedroom, Dining Kitchen & Common areas
- b) Edge cut Ceramic tiles for Balconies

Bath & Toilet

- a) Dado upto 10 feet with class -1 ceramic tiles
- b) Jaquar / ESS Branded sanitary ware
- c) Hot & Cold mixer unit with shower
- d) Eros / Hindware / Sona - Sanitary fittings (Branded)

Electrical

- a) Cobra / Kothari / Hify - ISI branded Wires
- b) Roma / Cona / Hify - ISI branded Switches
- c) One MCB for each flat
- d) Telephone point in Living room & Master bedroom
- e) Provision for Geyser, Exhaust fans
- f) Provision for A/C point

Kitchen

- a) 25mm thick Granite with high quality stainless steel Sink
- b) 2 to 2.6 feet Glazed tiles above 'L' shaped Granite kitchen platform area
- c) Provision for Aqua Guard, Grinding machine cooking range

Plastering

- a) All internal surface plastered & finished neatly with lime rendering
- b) All outside surface plastered with sponge finish

Painting

- a) For Interior walls - Quality Plastic Emulsion Paint
- b) For Exterior walls - Sandtex & Cement paints

Lift

- a) Branded Surya Elevators

Water supply

- a) 24hours Water supply from under ground water source

Power supply

- a) 24hrs power supply

