

100%
VAASTU

Your dream home is our aim



PROXIMITY & NEIGHBORHOOD

- a) Architecturally sound structure with provision for good interior & 100% Vaastu achieved by reputed Architects.
- b) Budget prices, Spacious and Quality construction by reputed builders.
- c) Adequate Parking facility for 4 wheelers & 2 wheelers in the stilt floor.
- d) Provision for gas connection point at utility.
- e) Located in south Bangalore city, near to most of the major places like, Shantinagar BMTC Bus stop, Shopping malls like, Brand Factory, Forum Mall, Big bazar, Major software companies like Accenture, IBM, Reputed education institutions like Christ College, Major Hospitals like Sagar Apollo, NIMHANS, Mahabodhi Mallige Hospital, Near to MICO Bosch, Near to Lalbagh Park.
- f) Approved by leading Financial Institutions.
- g) Interiors can be customized as per your requirements.



#455, 9th Cross, 1st Block
Near Madhavan Park
Jayanagar, Bangalore - 560 011
m. +91 96862 36845
t. +91 80 2656 2277
e. bhumikakss@rediffmail.com
w. www.bhumikabuilders.in

Architect:



TERRACE FLOOR PLAN

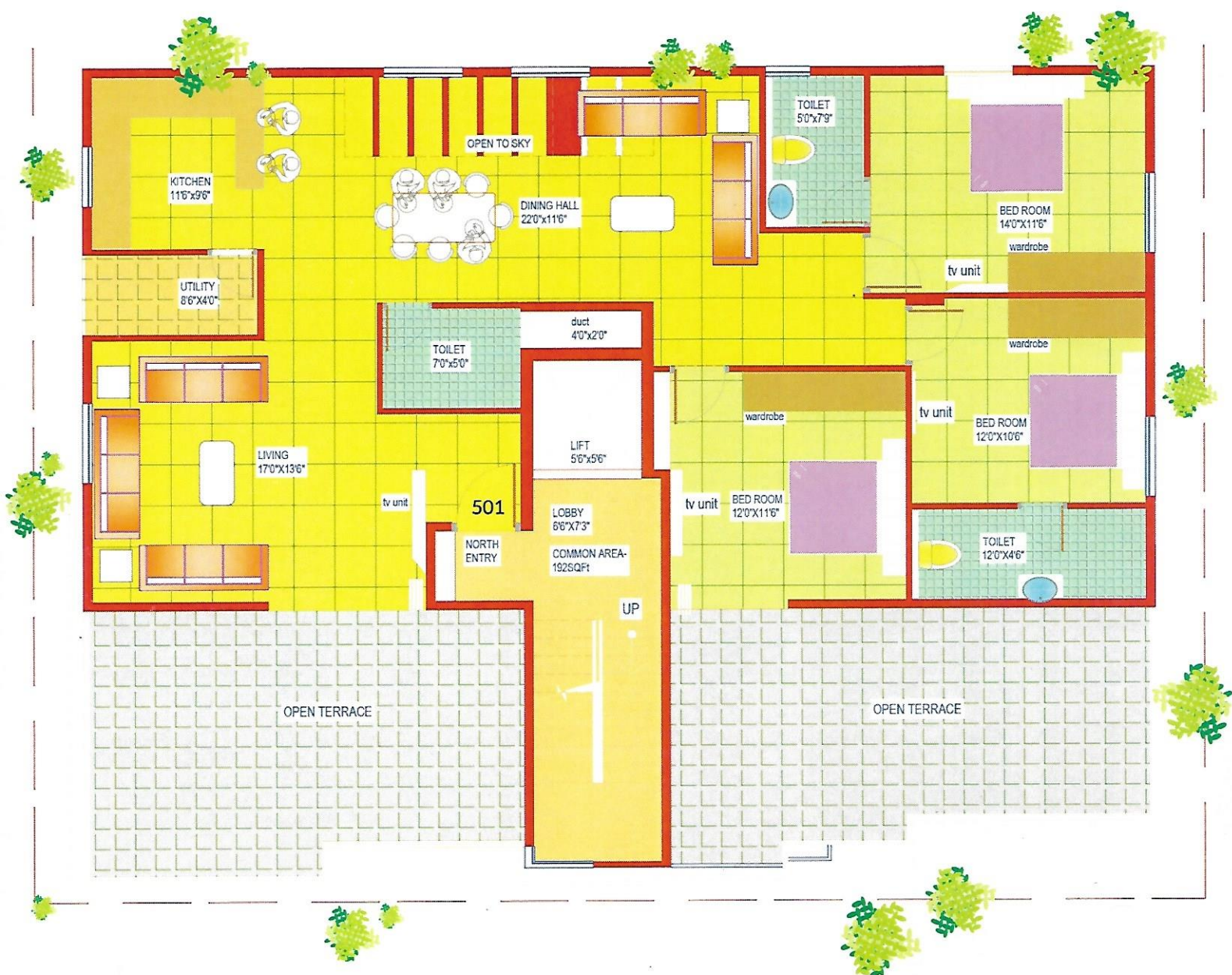

AREA STATEMENT

FLAT NO.	AREA
501	1,500.00SFT

S P E C I F I C A T I O N S

VAASTU

Built as per Vaastu

STRUCTURE

- a) RCC Framed Structure
- b) Solid concrete block masonry
- c) Stilt car parking
- d) Lift
- e) DJ set (Generator Backup)

DOOR & WINDOWS

- a) Main door in Teak wood
- b) All other door frames in Sal-wood & Flush door
- c) Water proof plywood shutter for Toilet and Balcony door
- d) Finesha windows with safety grills

FLOORING

- a) Granite flooring for Living, Bedroom, Dining Kitchen & Common areas
- b) Edge cut Ceramic tiles for Balconies

BATH & TOILET

- a) Dado upto 10 feet with class -1 ceramic tiles
- b) Jaquar / ESS Branded sanitary ware
- c) Hot & Cold mixer unit with shower
- d) Eros / Hindware / Sona - Sanitary fittings (Branded)

ELECTRICAL

- a) Finolex / Cobra / Hify - ISI branded Wires
- b) Roma / Cona / Hify - ISI branded Switches
- c) One MCB for each flat
- d) Telephone point in Living room & Master bedroom
- e) Provision for Geyser, Exhaust fans
- f) Provision for A/C point

KITCHEN

- a) 25mm thick Granite with high quality stainless steel Sink
- b) 2 to 2.6 feet Glazed tiles above 'L' shaped Granite kitchen platform area
- c) Provision for Aqua Guard, Grinding machine cooking range
- d) Provision for Copper pipeline for gas connection from the utility to the kitchen.

PLASTERING

- a) All internal surface plastered & finished neatly with lime rendering
- b) All outside surface plastered with sponge finish

PAINTING

- a) For Interior walls - Quality Plastic Emulsion Paint
- b) For Exterior walls - Sandtex & Cement paints

LIFT

- a) Branded Surya Elevators

WATER SUPPLY

- a) 24hours Water supply from Kaveri Water Supply and under ground water source.

POWER SUPPLY

- a) 24hrs power supply

